

# Neighborhood: Arcadia

## Proposed Zoning

- CC2
- LW1
- Neighborhood Node
- RD19
- RM15
- RS5

### MAP DESCRIPTION:

This map shows parcels and their proposed zoning district. Parcels not shown on the map are not being considered for rezoning.

### DISCLAIMER:

This map is a user-generated public output from a mapping software and is for reference only. Data layers on this map may or may not be accurate, current, or otherwise reliable. THIS MAP IS NOT TO BE USED FOR NAVIGATION. The changes shown on this map have not been finalized.

Learn about Proposed Updates to the

## Zoning Code & Map

**This project includes changes to commercial zoning districts & commercial development standards.**

Review these changes at [www.imaginekalamazoo.com/projects/zoningupdates](http://www.imaginekalamazoo.com/projects/zoningupdates).

These changes are intended to:

- Update old or out-of-date standards, some which were created in 2005.
- Align the Zoning Code with Imagine Kalamazoo & the 2025 Master Plan.
- Support economic development & community investment through better written & streamlined rules.

Utilice este código QR para esta información en español.

QUESTIONS? Contact 311 - OR - Christina Anderson, City Planner/CPED Deputy Director. [andersonc@kalamazoozoning.org](mailto:andersonc@kalamazoozoning.org)

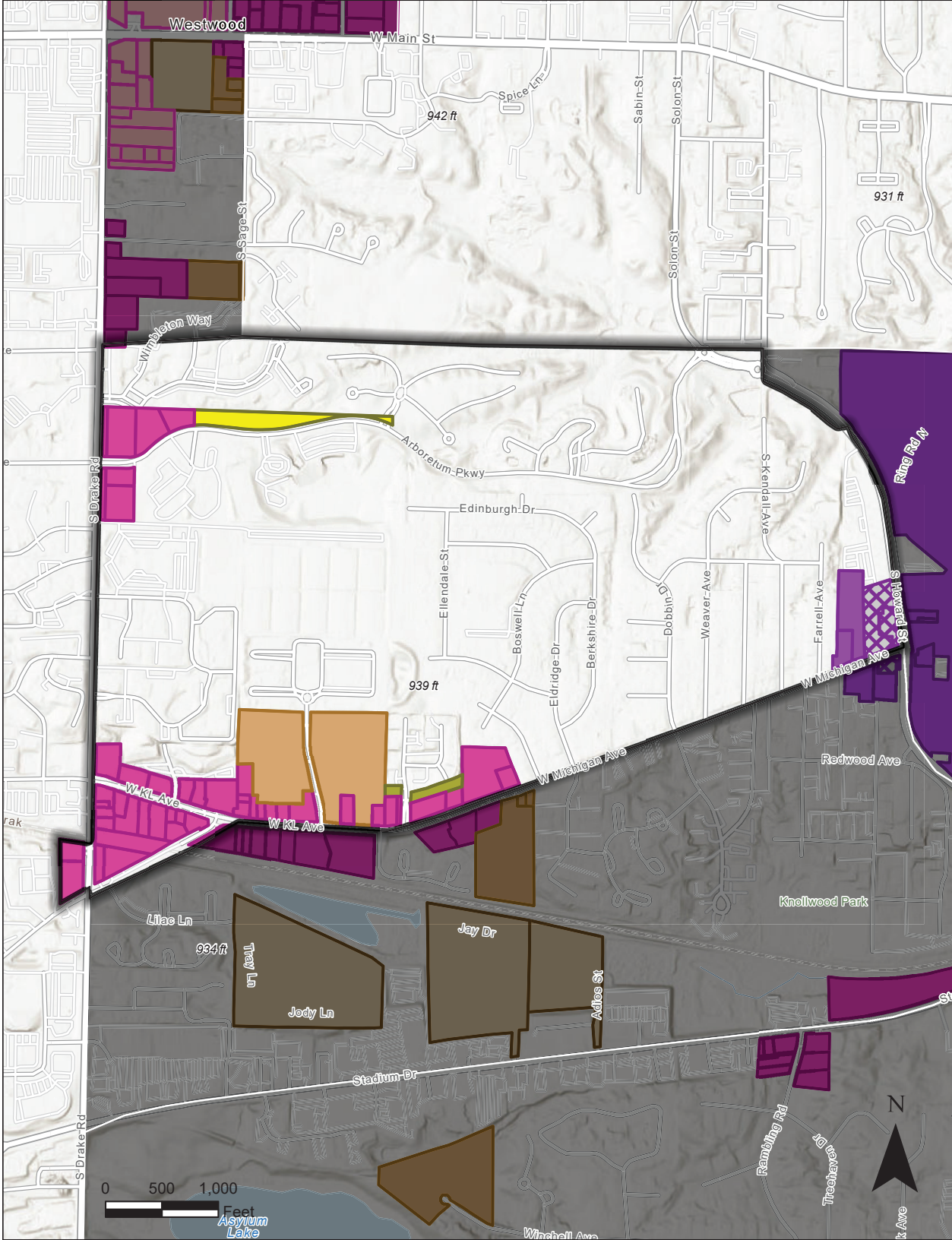

<b>Street Name</b>	<b>Full Property Address</b>	<b>Existing Zone</b>	<b>Proposed Zone</b>	<b>Neighborhood</b>
ARBORETUM	4400 ARBORETUM PKWY	CC/RS5	RS5	Arcadia
ARBORETUM	4620 ARBORETUM PKWY	CC	CC2	Arcadia
ARBORETUM	4510 ARBORETUM PKWY	CC	CC2	Arcadia
DRAKE	1560 S DRAKE RD	CC	CC2	Arcadia
DRAKE	1600 S DRAKE RD	CC	CC2	Arcadia
DRAKE	1325 S DRAKE RD	CC	CC2	Arcadia
DRAKE	1401 S DRAKE RD	CC	CC2	Arcadia
DRAKE	1441 S DRAKE RD	CC	CC2	Arcadia
DRAKE	1381 S DRAKE RD	CC	CC2	Arcadia
DRAKE	1655 S DRAKE RD	CC	CC2	Arcadia
DRAKE	1533 S DRAKE RD	CC	CC2	Arcadia
DRAKE	801 S DRAKE RD	CC	CC2	Arcadia
DRAKE	811 S DRAKE RD	CC	CC2	Arcadia
DRAKE	601 S DRAKE RD	CC	CC2	Arcadia
DRAKE	717 S DRAKE RD	CC	CC2	Arcadia
DRAKE	823 S DRAKE RD	CC	CC2	Arcadia
EMAJEAN	1344 EMAJEAN ST	CN-1/CC/RM15	RM15	Arcadia
JACK PINE	1401 JACK PINE DR	CN-1	RD19	Arcadia
JACK PINE	1314 JACK PINE DR	CN-1/CC/RD19	RD19	Arcadia
KL	4717 W KL AVE	CC	CC2	Arcadia
KL	4705 W KL AVE	CC	CC2	Arcadia
KL	4625 W KL AVE	CC	CC2	Arcadia
KL	4728 W KL AVE	CC	CC2	Arcadia
KL	4600 W KL AVE	CC	CC2	Arcadia
KL	4528 W KL AVE	CC	CC2	Arcadia
KL	4511 W KL AVE	CC	CC2	Arcadia
KL	4501 W KL AVE	CC	CC2	Arcadia
KL	4615 W KL AVE	CC	CC2	Arcadia
KL	4423 W KL AVE	CC	CC2	Arcadia
KL	4525 W KL AVE	CC	CC2	Arcadia
KL	4426 W KL AVE	CN-1/CC	CC2	Arcadia
KL	4500 W KL AVE	CC	CC2	Arcadia
KL	4510 W KL AVE	CC	CC2	Arcadia
MICHIGAN	2730 W MICHIGAN AVE	CN-1/RS5	LW1	Arcadia
MICHIGAN	3626 W MICHIGAN AVE	CN-1	CC2	Arcadia
MICHIGAN	3700 W MICHIGAN AVE	CN-1	CC2	Arcadia
MICHIGAN	3718 W MICHIGAN AVE	CN-1	CC2	Arcadia
MICHIGAN	3900 W MICHIGAN AVE	CN-1	CC2	Arcadia
MICHIGAN	2700 W MICHIGAN AVE	CN-1	LW1	Arcadia
MICHIGAN	2618 W MICHIGAN AVE	CN-1/RS5	Nhood Node	Arcadia
MICHIGAN	4520 W MICHIGAN AVE	CC	CC2	Arcadia
MICHIGAN	4316 W MICHIGAN AVE	CN-1/CC	CC2	Arcadia
MICHIGAN	4324 W MICHIGAN AVE	CN-1/CC	CC2	Arcadia
MICHIGAN	4328 W MICHIGAN AVE	CN-1/CC	CC2	Arcadia
MICHIGAN	4310 W MICHIGAN AVE	CN-1	CC2	Arcadia

MICHIGAN	4304 W MICHIGAN AVE	CN-1	CC2	Arcadia
MICHIGAN	4226 W MICHIGAN AVE	CN-1	CC2	Arcadia
MICHIGAN	4200 W MICHIGAN AVE	CN-1/CC	CC2	Arcadia
MICHIGAN	4012 W MICHIGAN AVE	CN-1/CC/RM15	RM15	Arcadia
MICHIGAN	3920 W MICHIGAN AVE	CN-1/CC	CC2	Arcadia
MICHIGAN	3928 W MICHIGAN AVE	CN-1/CC	CC2	Arcadia
MICHIGAN	4102 W MICHIGAN AVE	CN-1/RM15	CC2	Arcadia
MICHIGAN	4006 W MICHIGAN AVE	CN-1 /CC/RM15	CC2	Arcadia
MICHIGAN	2600 W MICHIGAN AVE	CN-1	Nhood Node	Arcadia